

4

3

2

1

THIS DRAWING IS UNPUBLISHED.

RELEASED FOR PUBLICATION

2011

LOC

DIST

REVISIONS

© COPYRIGHT 2011

ALL RIGHTS RESERVED.

| P | LTR | DESCRIPTION | DATE | DWN | APVD |
|---|-----|-------------------------------|-----------|-----|------|
| 3 | | UPDATED | 20MAY2011 | AB | GT |
| 4 | | REVISED | 02MAY2013 | KR | JC |
| 5 | | UPDATED | 18JUL2013 | MZ | JC |
| A | | PARTS RELEASED FOR PRODUCTION | 12NOV2013 | MZ | JC |

NOTES:

- 1 MATERIAL: PA GF (NATURAL AND BLACK COLOUR)
- 2 ALL POLARIZATION KEYS SHOWN FOR REF ONLY
- 3 WAYS I.D.
- 4 VOLTAGE AND CURRENT RATINGS
- 5 RIB CLOSING CAVITIES BY CHANGE OVER
- 6 TE LOGO
- 7 TE PART NUMBER
- 8 DATA CODE
- 9 AREA FOR AGENCIES APPROVAL LOGO
- 10 VISUAL INDOCATOR FOR PE CONDUCTOR

11) SEE C-DRAWING 293682 (LOCKING CAP) TO GET IP 40

- 12 IP CODE
- 13 CAVITY I.D.
- 14 POLARISATION KEY "TYPE D" SUITABLE FOR DALI APPLICATION
- 15 SLOTS TO ALLOW DELATCHING OPERATION. FOR DELATCHING TOOL AND OPERATION REFER TO APPLICATION SPEC.

5.60 PITCH (TYP X7)

SCALE 1:1

THIS DRAWING IS A CONTROLLED DOCUMENT.

DWN M. ZUCCA 31MAR2011

CHK M. ZUCCA 31MAR2011

APVD G. TURCO 31MAR2011

PRODUCT SPEC

APPLICATION SPEC

WEIGHT

DIMENSIONS:

mm

TOLERANCES UNLESS OTHERWISE SPECIFIED:

| | |
|--------|-------|
| 0 PLC | ± |
| 1 PLC | ±0.3 |
| 2 PLC | ±0.20 |
| 3 PLC | ± |
| 4 PLC | ± |
| ANGLES | ±3° |

MATERIAL NOTE 1

FINISH

NAME
STE TE Connectivity
 SOCKET HOUSING FREE HANGING
 NECTOR M-LINE 5 POLES
 UNSEALED VERSION

SIZE CAGE CODE DRAWING NO RESTRICTED TO

A300779 C-293615

Customer Drawing

SCALE 2:1

SHEET 1 OF 2

REV A

1470-19 (3/11)

THIS DRAWING IS UNPUBLISHED.

RELEASED FOR PUBLICATION

2011

© COPYRIGHT 2011

ALL RIGHTS RESERVED.

LOC

DIST

REVISIONS

| P | LTR | DESCRIPTION | DATE | DWN | APVD |
|---|-----|-------------|------|-----|------|
| - | | SEE SHEET 1 | - | - | - |
| | | | | | |
| | | | | | |

POLARIZATION TYPES

POLARIZATION TYPE "A"

POLARIZATION TYPE "B"

POLARIZATION TYPE "C"



PNs 0-293615-1
AND 1-293615-1

PNs 0-293615-2
AND 1-293615-2

PNs 0-293615-3
AND 1-293615-3

POLARIZATION TYPE "D"

POLARIZATION TYPE "E"



PNs 0-293615-4
AND 1-293615-4

PNs 0-293615-5
AND 1-293615-5

| KEYING | POL. KEYING | COLOUR | DESCRIPTION | REV. | PART NUMBER |
|--------|-------------|---------|--|------|-------------|
| | E | BLACK | SOCKET HOUSING FREE HANG. NECTOR* M-LINE 5 POLES | A | 1-293615-5 |
| | D | BLACK | SOCKET HOUSING FREE HANG. NECTOR* M-LINE 5 POLES | A | 1-293615-4 |
| | C | BLACK | SOCKET HOUSING FREE HANG. NECTOR* M-LINE 5 POLES | A | 1-293615-3 |
| | B | BLACK | SOCKET HOUSING FREE HANG. NECTOR* M-LINE 5 POLES | A | 1-293615-2 |
| | A | BLACK | SOCKET HOUSING FREE HANG. NECTOR* M-LINE 5 POLES | A | 1-293615-1 |
| | E | NATURAL | SOCKET HOUSING FREE HANG. NECTOR* M-LINE 5 POLES | A | 0-293615-5 |
| | D | NATURAL | SOCKET HOUSING FREE HANG. NECTOR* M-LINE 5 POLES | A | 0-293615-4 |
| | C | NATURAL | SOCKET HOUSING FREE HANG. NECTOR* M-LINE 5 POLES | A | 0-293615-3 |
| | B | NATURAL | SOCKET HOUSING FREE HANG. NECTOR* M-LINE 5 POLES | A | 0-293615-2 |
| | A | NATURAL | SOCKET HOUSING FREE HANG. NECTOR* M-LINE 5 POLES | A | 0-293615-1 |



THIS DRAWING IS A CONTROLLED DOCUMENT.

DWN M. ZUCCA 31MAR2011

CHK M. ZUCCA 31MAR2011

APVD G. TURCO 31MAR2011

PRODUCT SPEC

APPLICATION SPEC

WEIGHT

Customer Drawing

DIMENSIONS:
mm

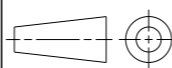

MATERIAL NOTE 1

TOLERANCES UNLESS OTHERWISE SPECIFIED:

| | |
|--------|-------|
| 0 PLC | ± |
| 1 PLC | ±0.3 |
| 2 PLC | ±0.20 |
| 3 PLC | ± |
| 4 PLC | ± |
| ANGLES | ±3° |
| FINISH | - |



NAME
SOCKET HOUSING FREE HANGING NECTOR M-LINE 5 POLES UNSEALED VERSION

SIZE CAGE CODE DRAWING NO RESTRICTED TO

A300779 C-293615 -

SCALE 2:1 SHEET 2 OF 2 REV A